

The ALSSERT DOORS ordering system will automatically generate the recommended no of hinges required for each door. This recommendation is determined by the height, width and weight of the door. Also, the weight of the panel will be shown in "Preview Door" to assist in calculating the correct type of other hardware applications.

Hinge drilling will be 35 mm holes only.

HINGED DOORS [full overlay, half overlay & inlay cup hinges]- ALL PROFILES

Minimum Height - 250 mm Maximum Height - 2400 mm
 Minimum Width - 150 mm Maximum Width - 800 mm
 Minimum Face Area - 0.06 sq metres Maximum Face Area - 1.8 sq metres

LAMINATED GLASS as above except Maximum Face Area - 1.56 sq metres

UNDRILLED PANELS - ALL PROFILES

Minimum Height - 250 mm Maximum Height - 2400 mm
 Minimum Width - 150 mm Maximum Width - 1200 mm
 Minimum Face Area - 0.06 sq metres Maximum Face Area - 2.4 sq metres

LAMINATED GLASS Size as above except Maximum Face Area - 2.2 sq metres.

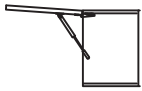

STRUT DOOR HK-XS - ALL PROFILES

Minimum Height - 210 mm Maximum Height - 600 mm
 Minimum Width - 250 mm Maximum Width - 750 mm
 Minimum Face Area - 0.05 Sq metres Maximum Face Area - 0.45 Sq metres

LAMINATED GLASS

Minimum Height - 210 mm Maximum Height - 600 mm
 Minimum Width - 250 mm Maximum Width - 650 mm
 Minimum Face Area - 0.05 Sq metres Maximum Face Area - 0.49 Sq metres

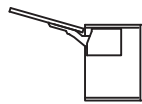

SPRING FLAP DOOR HK - ALL PROFILES

Minimum Height - 210 mm Maximum Height - 600 mm
 Minimum Width - 300 mm Maximum Width - 1750 mm
 Minimum Face Area - 0.07 Sq metres Maximum Face Area - 1.08 Sq metres

LAMINATED GLASS

Sizes as shown left except Maximum Face Area - 0.9 Sq metres

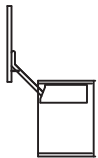

MICROWAVE DOOR HL - ALL PROFILES

Minimum Height - 300 mm Maximum Height - 580 mm
 Minimum Width - 300 mm Maximum Width - 1650 mm
 Minimum Face Area - 0.09 Sq metres Maximum Face Area - 1.04 Sq metres

LAMINATED GLASS

Sizes as shown left except Maximum Face Area - 0.98 Sq metres



UP & OVER DOOR HS - ALL PROFILES

Minimum Height - 350 mm Maximum Height - 800 mm
 Minimum Width - 400 mm Maximum Width - 1800 mm
 Minimum Face Area - 0.14 Sq metres Maximum Face Area - 1.44 Sq metres

LAMINATED GLASS

Sizes as shown left except Maximum Face Area - 1.2 Sq metres

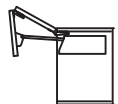

LIFT UP BI-FOLD DOOR HF - BOX PROFILES only SIZING is OVERALL for 1 PAIR of Doors

Minimum Height - 480 mm Maximum Height - 1040 mm
 Minimum Width - 300 mm Maximum Width - 1800 mm
 Minimum Face Area - 0.144 Sq metres Maximum Face Area - 1.35 Sq metres

LAMINATED GLASS

Sizes as shown left except Maximum Face Area - 1.13 Sq metres

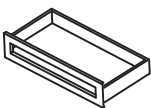

DRAWER FRONTS - ALL PROFILES

Minimum Height - 130 mm Maximum Height - 2400 mm
 Minimum Width - 140 mm Maximum Width - 2400 mm
 Minimum Face Area - 0.035 Sq metres Maximum Face Area - 2.88 Sq metres

LAMINATED GLASS

Sizes as shown left except Maximum Face Area - 2.2 Sq metres

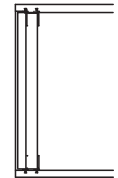

BOTTOM RUNNING SLIDING DOORS for cabinets only - BOX PROFILES only.

Minimum Height - 150 mm Maximum Height - 2400 mm
 Minimum Width - 300 mm Maximum Width - 1200 mm
 Minimum Face Area - 0.045 Sq metres Maximum Face Area - 2.4 Sq metres

LAMINATED GLASS

Sizes as shown left except Maximum Face Area - 2.08 Sq metres

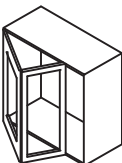

OVERLAY SLIDING BI-FOLD DOORS for cabinets only - BOX PROFILES only. SIZING is OVERALL for 1 PAIR of Doors

Minimum Height - 250 mm Maximum Height - 2200 mm
 Minimum Width - 450 mm Maximum Width - 1000 mm
 Minimum Face Area - 0.135 Sq metres Maximum Face Area - 1.65 Sq metres

LAMINATED GLASS

Sizes as shown left except Maximum Face Area - 1.4 Sq metres

Available either as 1 PAIR or 2 PAIR.

Other Bi-Fold Door options are available, please contact us

Face Area is **Height X Width** e.g. For a hinged door of 700 mm x 500 mm the Face Area is .35 Sq metres [$0.7 \times 0.5 = .35$].

If you require a hinged door 2400 mm high, divide the maximum face area of 1.8 Sq metres by 2.4 = .75.

Therefore the maximum width door available for a height of 2400 mm is 750 mm.

For Laminate Glass, which is heavier, divide 1.56 Sq metres by 2.4 to find the maximum width door available is 650 mm.

Where the doors are bi-fold the areas shown are for the 2 doors combined.

Information compiled in accordance with hardware manufacturer's guidelines.